

M1 STEP LIGHT SOLID EYELID

PRODUCT CONFIGURATION

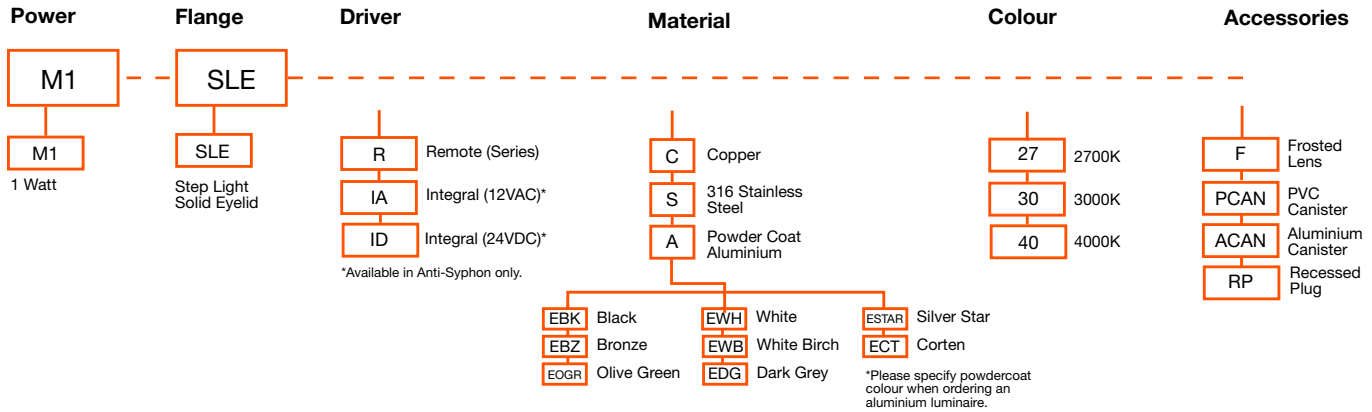

SPECIFICATIONS

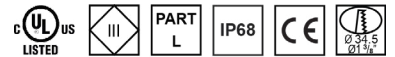

Power	1 Watt
Ingress Protection Rating	IP68
Material	Natural Copper, 316 Stainless Steel or Powder Coated Aluminium
Removable Light Engine	Pin Mounted 1W 3vf Cree XPG-3 Chip
LED Life Expectancy	50,000 Hours L70
LED Shield	LED Bypass Shunt Reverse polarity protection
Colour Temperature	Warm White - 2700K and 3000K Neutral White - 4000k, Red, Green, Blue or Amber
CRI	90+ CRI
Optic Degrees	Asymmetric Wash
Lens Cover	Clear and Frosted
Efficacy	80 lm/w - Delivered from Luminaire with an unobstructed beam
Input	350mA 3vdc Constant current (Remote) 12VAC (Integral) 24VDC (Integral)
Warranty	Electronics Warranty 5 Years

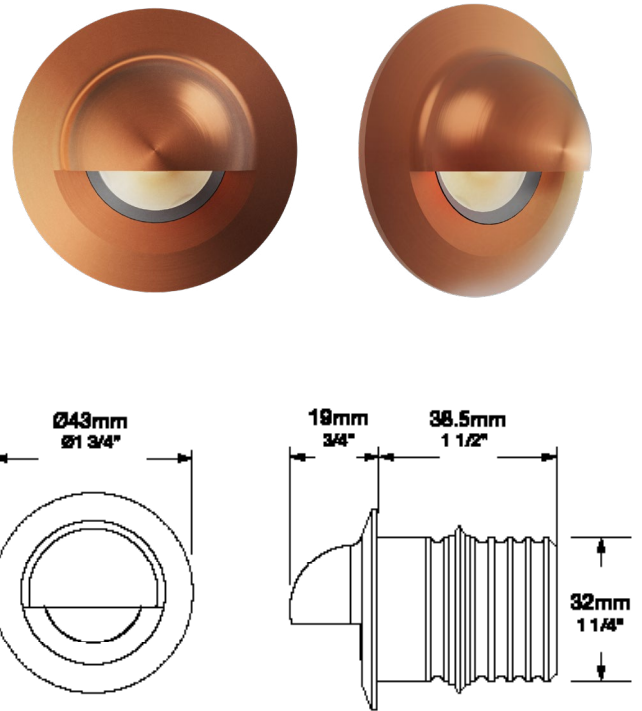

ACCESSORIES

The M1SLE fits within either the PVC recessed canister or Aluminium recessed canister (Please refer to the canister spec sheets for full specifications). A recessed plug is also available for wall mounting.

INSTALLATION RECOMMENDATIONS

Using the PVC or aluminium mounting canister will make recessed installation of this product simple. Core a hole in an existing wall or cast the canister in. Once in place, simply push the fitting into the conduit hole. The luminaire will be retained by a silicon wiper seal.

*Due to continued product enhancements, specifications may change without notification

BEAM ANGLES

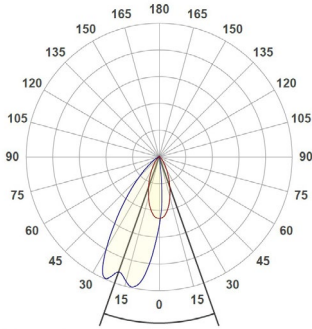

Asymmetric

REPLACING COMPONENTS

Unscrew the flange paying close attention to the assembly order or refer to the diagram below. Locate the item that needs to be replaced, it is imperative you replace the component with factory LuxR parts to ensure correct operation of the luminaire. When reassembling make sure all the components are in their correct order to ensure water tightness and correct light output.

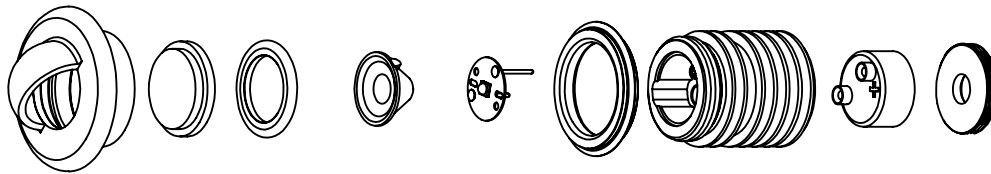

REMOTE DRIVER WIRED IN SERIES

Often referred to as series wiring the current in a series circuit follows one path from start-to-finish with the positive of the second LED connected to the negative of the first. Series wiring allows a single driver to be mounted remotely, powering a number of series fittings. Often the most simplest of wiring schemes as each fitting is connected to the next in a daisy chain. It removes the need for a smaller 12 volt driver in each fitting.

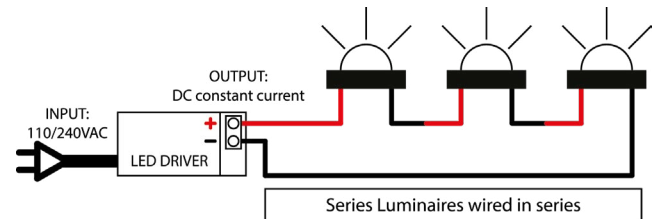

INTEGRAL DRIVER + TRANSFORMER

In a parallel circuit all the positive connections are tied together and back to the positive output of the LED driver and all the negative connections are tied together and back to the negative output of the driver. The integral driver option allows LuxR fittings to be wired in parallel to existing or new installations where a wire wound or magnetic transformer is being used.

24VDC Integral Driver

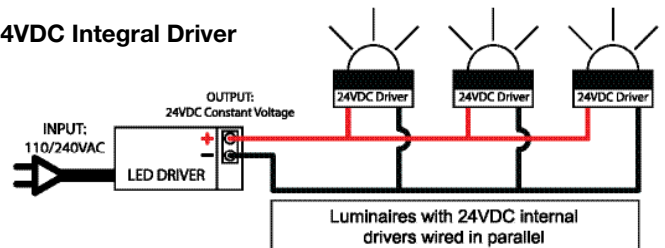

Integral (12VAC-24VDC) Driver Housing

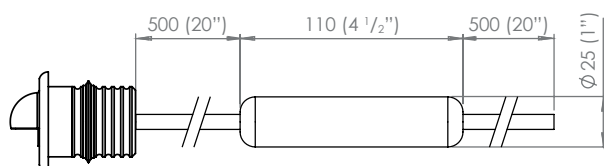

12VAC Integral Driver

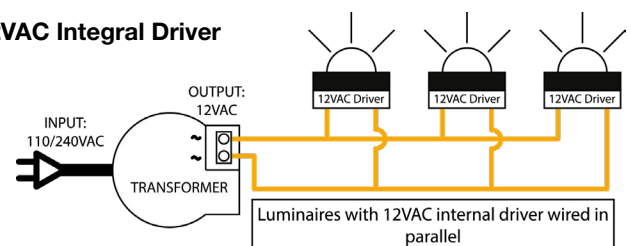

*Due to continued product enhancements, specifications may change without notification